

SINGLE AXLE ALL-AROUND UTILITY TRAILER

G.V.W.R.	1500#	AXLE	2000# Axle
G.A.W.R.	1810#	SUSPENSION	Multi-Leaf Slipper Spring
COUPLER	2" Coupler	TIRE	20.5 x 8.0-10 Load Range B
SAFETY CHAINS	¼" Grd. 30 w/Safety Latch Hook (2 ea.)	WHEEL	10 x 6 5 Bolt
JACK	(none)	FLOOR	Expanded Metal
TONGUE	Single 2 x 3 Tubing (Cold Formed)	LIGHTS	D.O.T. Stop, Tail, Turn and Clearance
FRAME	2 x 2 x 1/8 Angle	ELEC. PLUG	4 Way Flat w/ Loom
CROSSMEMBER	2 x 2 x 1/8 Angle	FINISH (PREP)	Acid Etched w/White Phosphorus, & Two Coats Primer
FENDERS	9" x 26" Jeep Style	FINISH	Painted w/ 2 Coats High Solid <i>Supreme</i> Acrylic Automotive Grade Enamel
SIDES	14 Ga Fabricated Smooth		

STANDARD FEATURES

- 12" Solid Fabricated Sides
- Expanded Metal Floor For Easy Cleaning
- Lower Tongue Support & Handle
- 3' Tubular Rampgate w/ Exp. Mtl.
- Cold Formed Tubular Raised Tongue
- Safety Chains Attached w/ Cold Rolled Eyelets

15AA-8

DIMENSIONS			
LENGTH	A	B	C
8'	96"	43"	53"

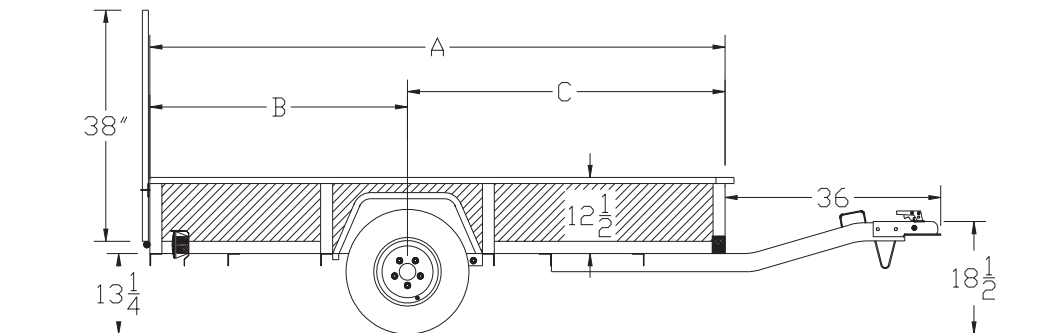

PRICING

MODEL #	WEIGHT	DESCRIPTION	
15AA-8	300#	50" X 8' Single Axle All-Around	

*Standard Color is Green Camouflage